

C/S Allway® Expansion Joint Covers

All Metal™ Floor Joint Covers (Interior/Exterior Joints to 100mm)

All Metal™ recess mounted floor joint covers are designed to accommodate up to 100% horizontal movement of the joint width. Vertical movement is engineered to allow for non-aligning opposing slabs.

Standard Models

ALS

Floor joint covers utilising a free-floating centre plate held in position by serrated aluminium cover plates snap-locked into aluminium frames.

ALSW

The floor to wall version of ALS

ALSM

The new to existing version of ALS

ALX

Floor covers incorporating stainless steel centre plate and cover plates

ALXW

The floor to wall version of ALX

Heavy Duty Models

AL-HD

Heavy duty floor joint covers for up to 100mm wide joints

AL-HDC

AL-HD with secondary centre plate for areas where trolley traffic is prevalent.

ALW-HD

The floor to wall version of AL-HD

ALM-HD

The new to existing version of the AL-HD

Colours

Aluminium sections are mill finished as standard, except for centre plate and cover plates on ALS/W models which are supplied with clear anodised finish. Centre plate and cover plates for ALX/W models are in dull polished stainless steel as standard. Other colours can be supplied subject to minimum quantity.

ALS-200. All Metal™ floor-to-floor joint cover.

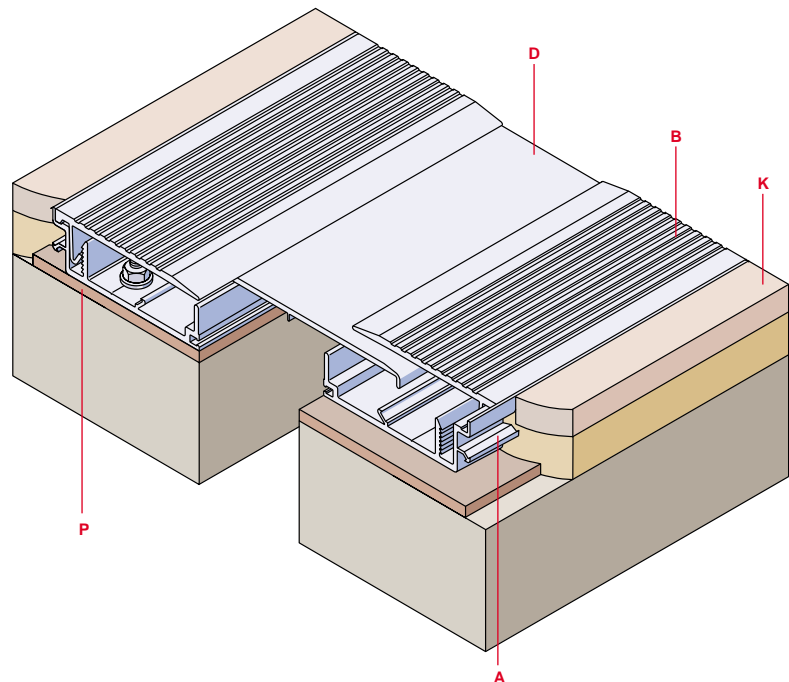

Product Data

Model	Number	Joint Width (mm)	Exposed Surface (mm)	Thermal Movement Capacity ±(mm)		
				Horizontal	Vertical	Lateral
ALS	100	25.0	127.0	±25.0	±3.0	∞
	200	50.0	197.0	±50.0	±3.0	∞
	300	75.0	273.0	±75.0	±3.0	∞
	400	100.0	299.0	±75.0	±3.0	∞
ALSW	100	25.0	76.0	±12.0	±3.0	∞
	200	50.0	124.0	±25.0	±3.0	∞
	300	75.0	175.0	±38.0	±3.0	∞
	400	100.0	200.0	±38.0	±3.0	∞
ALSM	100	25.0	127.0	±12.0	±3.0	∞
	200	50.0	174.0	±25.0	±3.0	∞
	300	75.0	224.0	±38.0	±3.0	∞
	400	100.0	249.0	±38.0	±3.0	∞
ALX	100	25.0	175.0	±20.0	0	∞
	200	50.0	200.0	±40.0	0	∞
ALXW	100	25.0	100.0	±10.0	0	∞
	200	50.0	125.0	±20.0	0	∞
AL-HD	100	25.0	127.0	±20.0	±3.0	∞
	200	50.0	228.0	±50.0	±3.0	∞
	400	100.0	318.0	±70.0	±3.0	∞
	400	100.0	318.0	±70.0	±3.0	∞
AL-HDC	200	50.0	228.0	±25.0	±3.0	∞
ALW-HD	100	25.0	76.0	±10.0	±3.0	∞
	200	50.0	139.0	±25.0	±3.0	∞
	400	100.0	210.0	±34.0	±3.0	∞
ALM-HD	200	50.0	190.0	±25.0	±3.0	∞
	400	100.0	260.0	±34.0	±3.0	∞

ALM-200HD. All Metal™ heavy duty new to existing floor-to-floor joint cover.

Note: FFL at this level should be 6mm higher than the existing floor level

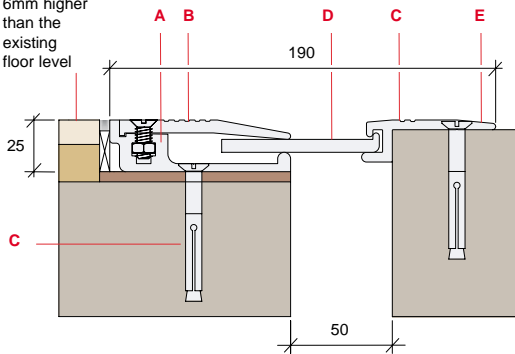

ALX-200. All Metal™ floor-to-floor joint cover.

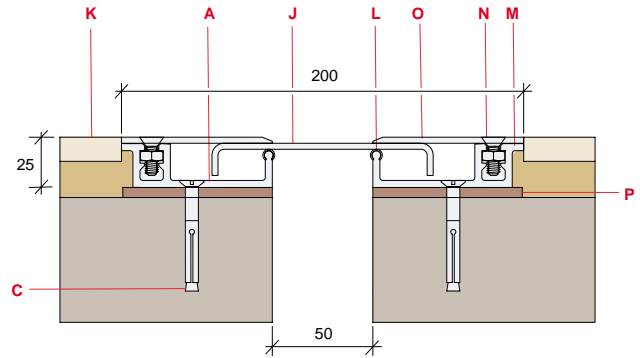

AL-200HD. All Metal™ heavy duty floor-to-floor joint cover.

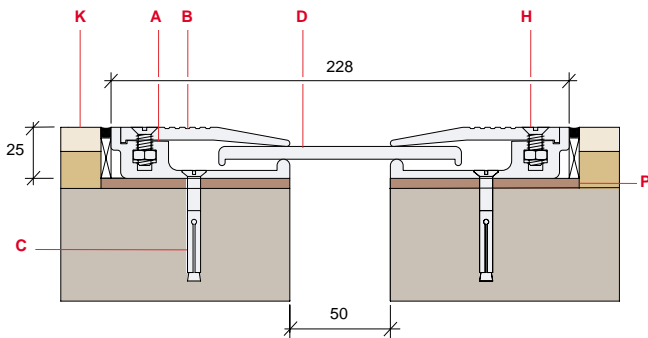

AL-200HDC. All Metal™ heavy duty floor-to-floor joint cover.

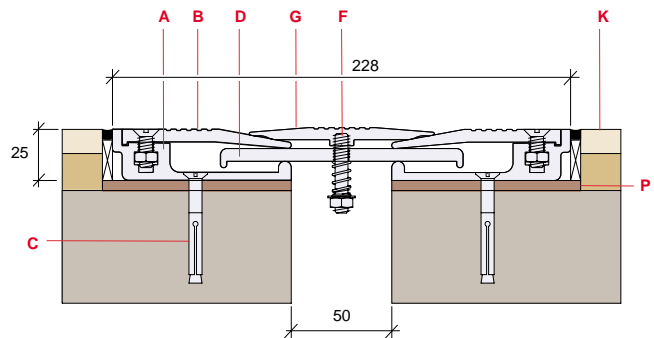

Key for diagrams

- A. Continuous extruded aluminium side frame (mill finished)
- B. Continuous extruded aluminium serrated cover plate (mill finished for heavy duty models, clear anodised for ALS (W/M) series models)
- C. Fixing to suit substrate (by others), please refer to Product Data Sheet
- D. Continuous extruded aluminium centre plate
- E. Continuous extruded aluminium serrated side frame (mill finished)
- F. M6 x38mm special securing bolt and spring assembly @ 600mm centres
- G. Continuous extruded aluminium secondary centre plate (mill finished)
- H. 6.4mm flat headed machine screw and nut @ 250mm centres
- J. Dull polished stainless steel centre plate
- K. Floor finish
- L. Vinyl isolation liner
- M. Isolation tape separation between stainless steel and aluminium surfaces.
- N. Machine screw fixings @ 300mm centres
- O. Dull polished stainless steel cover plate
- P. Non-shrink self-levelling bedding compound (by others)

Specification Style

Supply and install 90 metres C/S Allway All Metal™ series floor-to-floor expansion joint cover, model ref: ALS-300.

Optional Clauses:

- i) Reflex Fire Barrier, to suit 75mm joint width and providing minimum 2 hours integrity and insulation when installed in accordance with manufacturer's instructions.
- ii) Vapour Barrier/Water Stop to suit 75mm joint width.

All manufactured and supplied by Construction Specialties (UK) Ltd, Conspec House, St Andrews Way, Bicester Road, Aylesbury, Bucks HP19 8AF
Tel: 01296 611000

C/S Allway® Expansion Joint Covers

All Metal™ Large Span Floor Joint Covers (Interior/Exterior Joints to 250mm)

All Metal™ floor joint covers designed to span structural joints ranging from 100mm to 250mm. All floor-to-floor joints are working on a rotating centre-pivot design allowing up to ±50% horizontal movement of the working joint width.

- Self-centering centre plate with stainless steel turnbar assembly
- Bronze and stainless steel covers available

Standard Models

SJP

Aluminium floor joint covers with a cover plate sitting over a standard floor finish

SJPW

Floor to wall version of SJP

SJPF

Aluminium floor joint covers with a flush fitting cover plate

SJPFW

Floor to wall version of SJPF

Heavy Duty Models

SJ-HD

Heavy duty version of SJPF series

SJW-HD

Floor to wall version of SJ-HD

Colours

Aluminium sections – mill finished as standard, except for exposed surfaces on standard models, which are supplied with clear anodised finish. Other colours can be supplied subject to minimum quantity.

SJ-400HD. All Metal™ Large Span heavy duty floor-to-floor cover.

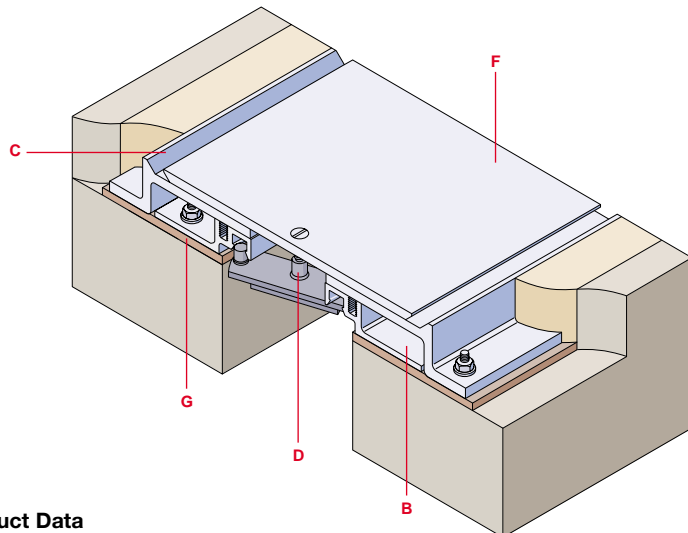

Product Data

Model	Number	Joint Width (mm)	Exposed Surface (mm)	Thermal Movement Capacity ±(mm)			
				Horizontal	Vertical	Lateral	
SJP*	200	50.0	89.0	±25.0	0	±50.0	
	300	75.0	165.0	±37.0	0	±50.0	
	400	100.0	191.0	±50.0	0	±50.0	
	500	125.0	267.0	±62.0	0	±50.0	
	600	150.0	302.0	±75.0	0	±50.0	
	700	175.0	343.0	±87.0	0	±50.0	
SJPW*	800	200.0	381.0	±100.0	0	±50.0	
	900	225.0	419.0	±112.0	0	±50.0	
	1000	250.0	454.0	±125.0	0	±50.0	
	200	50.0	82.0	±12.0	0	±25.0	
SJPF	300	75.0	121.0	±19.0	0	±25.0	
	400	100.0	146.0	±25.0	0	±25.0	
	500	125.0	191.0	±32.0	0	±25.0	
	600	150.0	229.0	±37.0	0	±25.0	
	700	175.0	260.0	±44.0	0	±25.0	
	800	200.0	292.0	±50.0	0	±25.0	
	900	225.0	324.0	±57.0	0	±25.0	
	1000	250.0	356.0	±63.0	0	±25.0	
	SJPFW	200	50.0	140.0	±12.0	0	±12.0
		300	75.0	178.0	±12.0	0	±12.0
400		100.0	216.0	±12.0	0	±12.0	
500		125.0	254.0	±12.0	0	±12.0	
600		150.0	292.0	±12.0	0	±12.0	
200		50.0	92.0	±6.0	0	±6.0	
SJ-HD	300	75.0	127.0	±6.0	0	±6.0	
	400	100.0	159.0	±6.0	0	±6.0	
	500	125.0	191.0	±6.0	0	±6.0	
	600	150.0	222.0	±6.0	0	±6.0	
	400	100.0	222.0	±25.0	0	±12.0	
	500	125.0	248.0	±25.0	0	±12.0	
SJW-HD	600	150.0	298.0	±25.0	0	±12.0	
	700	175.0	349.0	±25.0	0	±12.0	
	800	200.0	375.0	±25.0	0	±12.0	
	400	100.0	162.0	±12.0	0	±6.0	
SJW-HD	500	125.0	187.0	±12.0	0	±6.0	
	600	150.0	226.0	±12.0	0	±6.0	
	700	175.0	264.0	±12.0	0	±6.0	
	800	200.0	314.0	±12.0	0	±6.0	

These joint covers can be used in seismic areas. * Larger sizes available. For details contact our Technical Department on 01296 611000

SJW-400HD. All Metal™ Large Span heavy duty floor-to-wall joint cover.

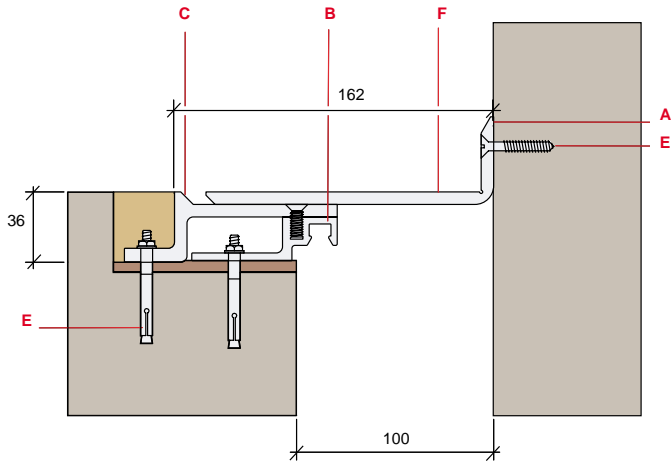

Key for diagrams

- A. Aluminium centre plate with clear anodised finish
- B. Continuous extruded aluminium turnbar frame
- C. Continuous extruded aluminium heavy duty frame (mill finished)
- D. Steel turnbar assembly @ 450mm centres
- E. Fixing to suit substrate (by others), please refer to Product Data Sheet
- F. Aluminium centre plate (angled for SJW-HD models) supplied mill finished
- G. Non-shrink self levelling bedding compound (by others)
- H. Floor finish

Specification Style

Supply and install 40 meters C/S Allway All Metal™ Large Span floor to floor expansion joint cover, model ref: SJP-800.

Optional Clauses:

- i) Multiflex Fire Barrier, to suit 200mm joint width and providing minimum 2 hours integrity and insulation when installed in accordance with manufacturer's instructions.
- ii) Vapour Barrier/Water Stop to suit 200mm joint width.

All manufactured and supplied by Construction Specialties (UK) Ltd, Conspec House, St Andrews Way, Bicester Road, Aylesbury, Bucks HP19 8AF Tel: 01296 611000

SJP-400. All Metal™ Large Span floor-to-floor joint cover.

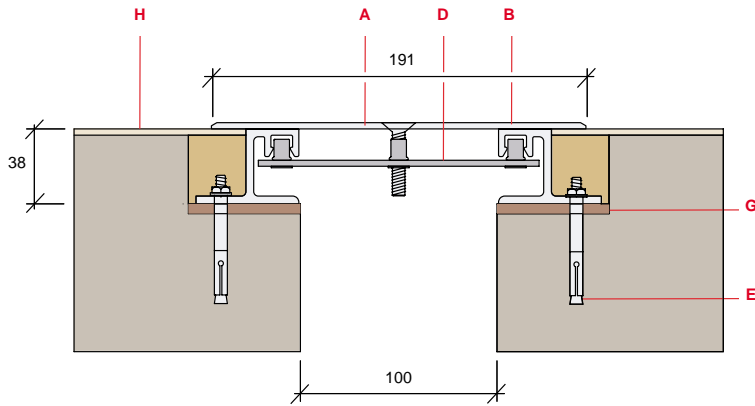

SJPF-400. All Metal™ Large Span floor-to-floor joint cover.

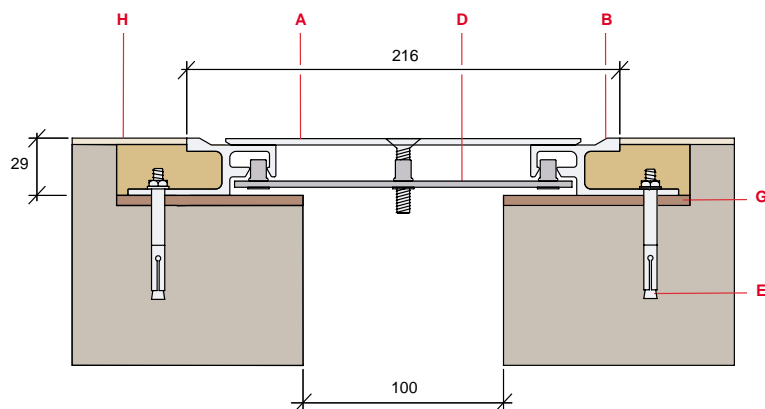

C/S Allway® Expansion Joint Covers

All Metal™ Wall and Ceiling Joint Covers (Interior Joints to 50mm)

Series of aluminium surface mounted wall joint covers which can be used as ceiling joint covers where the construction permits.

SM

Wall joint covers for 25mm and 50mm joints.

SMC

The corner version of SM.

Colours

Standard finish is clear anodise. Other colours, or polyester powder coating, available subject to minimum quantity.

SM-200. All Metal™ wall-to-wall joint cover.

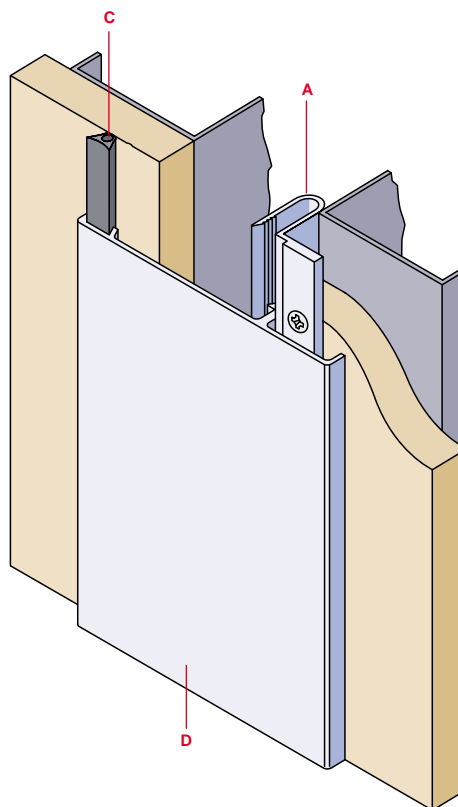

SMC-200. All Metal™ corner wall joint cover.

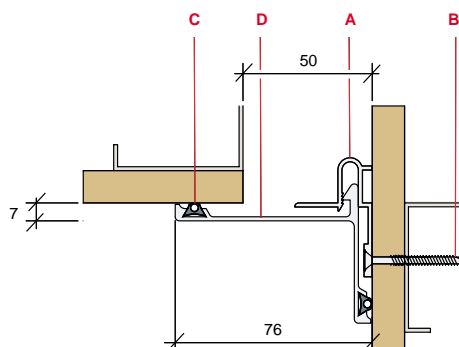

Key for diagrams

- A. Continuous extruded aluminium anchor clip
- B. Fixing to suit substrate (by others), please refer to Product Data Sheet
- C. Gasket
- D. Continuous extruded aluminium cover plate

Specification style

Supply and install 38 metres C/S Allway All Metal™ wall to wall expansion joint cover, model ref: SM-200.

Optional Clauses:

- i) Reflex Fire Barrier, to suit 50mm joint width and providing minimum 2 hours integrity and insulation when installed in accordance with manufacturer's instructions.

All manufactured and supplied by Construction Specialties (UK) Ltd, Conspec House, St Andrews Way, Bicester Road, Aylesbury, Bucks HP19 8AF.
Tel: 01296 611000

Product Data

Model	Number	Joint Width (mm)	Exposed Surface (mm)	Thermal Movement Capacity ±(mm)		
				Horizontal	Vertical	Lateral
SM	100	25.0	63.0	±16.0	0	0
	200	50.0	102.0	±25.0	0	0
SMC	100	25.0	45.0	±16.0	0	0
	200	50.0	76.0	±25.0	0	0