

C/S Allway® Expansion Joint Covers

Thinline Flush Seal™ Floor Joint Covers (Interior Joints to 50mm)

Series of surface mounted floor joint covers incorporating a dual durometer thermoplastic rubber gasket.

- Replaceable gasket
- Smooth, easy clean surface
- No blockout required

GFS

The easy to install surface mounted floor joint covers

GFSW

The floor to wall versions of GFS

GFPS

An alternative to GFS joint covers where the exposed aluminium frames are recessed to take a 5mm thick carpet or vinyl floor finish

GFPSW

The floor to wall version of GFPS

GFST

An alternative to GFPS joint covers where the carpet or vinyl floor finish butts up to the edge of the aluminium frames

GFSTW

The floor to wall version of GFST

Colours

Aluminium Sections - standard finish is clear anodise except for GFPS(W) models, where side frame is supplied mill finished. Other colours can be supplied subject to minimum quantity.

C/S TPR Gaskets – supplied in rolls up to 30 metres in length, in Black, White, Grey and Greige as standard (see general information page 34). Other colours can be made available, subject to quantity.

GFS-80. Thinline Flush Seal™ floor-to-floor joint cover.

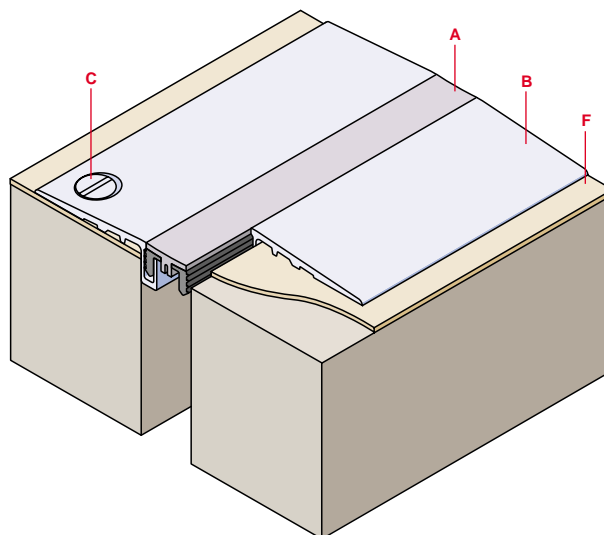

Product Data

Model	Number	Joint Width (mm)	Exposed Surface (mm)	Thermal Movement Capacity ±(mm)			Complementary Wall/Ceiling Joint Covers
				Horizontal	Vertical	Lateral	
GFS	80	20.0	105.0	±3.0	0	0	FGFS-80
	100	25.0	111.0	±5.0	±3.0	±1.5	FGFS-100
	200	50.0	129.0	±10.0	±3.0*	±3.0	FGFS-200
GFSW	80	20.0	62.0	±3.0	0	0	FGFSC-80
	100	25.0	67.0	±5.0	±3.0	±1.5	FGFSC-100
	200	50.0	90.0	±10.0	±3.0*	±3.0	FGFSC-200
GFPS	80	20.0	23.0	±3.0	0	0	N/A
	100	25.0	30.0	±5.0	±3.0	±1.5	FWF-100
	200	50.0	48.0	±10.0	±3.0*	±3.0	FWF-200
GFPSW	80	20.0	22.0	±3.0	0	0	N/A
	100	25.0	28.0	±5.0	±3.0	±1.5	FWFC-100
	200	50.0	48.0	±10.0	±3.0*	±3.0	FWFC-200
GFST	100	25.0	111.0	±5.0	±3.0	±1.5	FGFS-100
	200	50.0	130.0	±10.0	±3.0*	±3.0	FGFS-200
GFSTW	100	25.0	68.0	±5.0	±3.0	±1.5	FGFSC-100
	200	50.0	90.0	±10.0	±3.0*	±3.0	FGFSC-200

* No vertical movement when joint in compression.

GFPS-100. Thinline Flush Seal™ floor-to-floor joint cover.

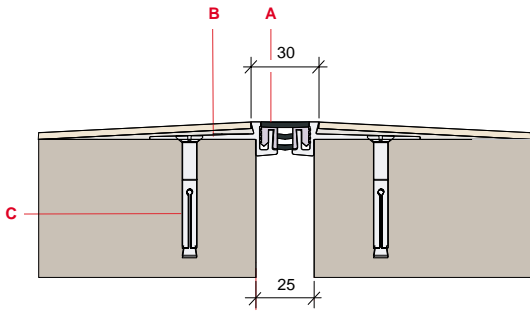

GFST-200. Thinline Flush Seal™ floor-to-floor joint cover.

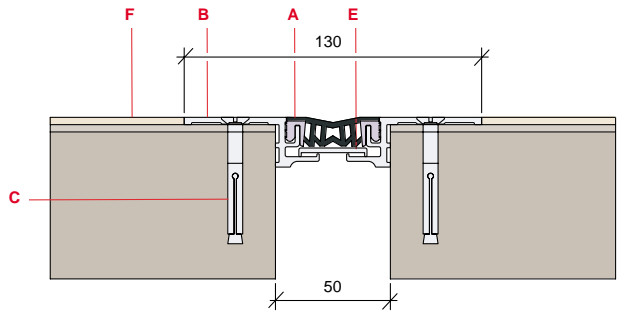

GFSW-80. Thinline Flush Seal™ floor-to-wall joint cover.

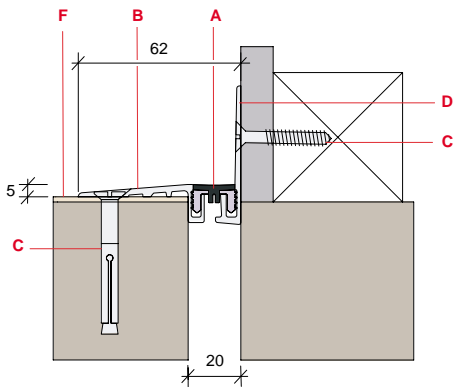

GFSTW-200. Thinline Flush Seal™ floor-to-wall joint cover.

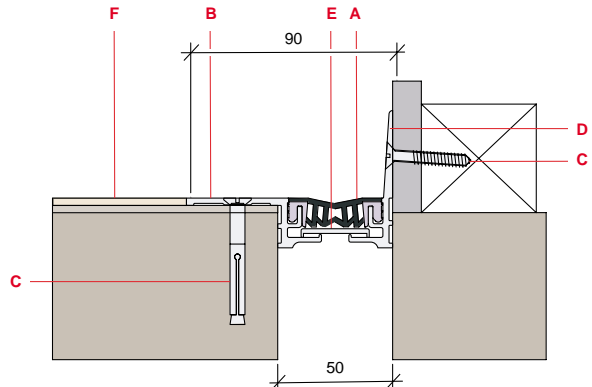

Key for diagrams

- A. C/S TPR gasket
- B. Continuous extruded aluminium side frame with clear anodised finish (mill finished for GFPS(W) models)
- C. Fixing to suit substrate (by others), please refer to Product Data Sheet
- D. Continuous extruded aluminium wall frame with clear anodised finish
- E. Continuous extruded aluminium centre plate (mill finished)
- F. Floor finish

Specification Style

Supply and install 120 metres C/S Allway Thinline Flush Seal™ series floor to floor expansion joint cover, model ref: GFST-200, complete with Grey C/S TPR gasket.

Optional Clauses:

- i) Reflex Fire Barrier, to suit 50mm joint width and providing minimum 2 hours integrity and insulation when installed in accordance with manufacturer's instructions.
- ii) Vapour Barrier/Water Stop to suit 50mm joint width.

All manufactured and supplied by Construction Specialties (UK) Ltd, Conspic House, St Andrews Way, Bicester Road, Aylesbury, Bucks HP19 8AF
Tel: 01296 611000

C/S Allway® Expansion Joint Covers

Thinline Flush Seal™ Floor Joint Covers (Interior Joints to 50mm)

Series of 25mm and 50mm wide recess mounted floor joint covers incorporating a dual durometer thermoplastic rubber gasket, available in various frame depths

- Flush floor finish
- Replaceable gasket
- Smooth, easy clean surface
- Multi-directional movement

GFT

The standard embedded joint covers for floor joints up to 50mm wide, available in four frame depths. Can be fitted flush to the floor screed or left proud to butt up to a carpet or vinyl finish

GFTW

The floor to wall versions of GFT

GFTB

As the GFT but with a brass frame cap edging the gasket, available with 51mm deep frame only

GFTBW

The floor to wall version of GFTB

Colours

Aluminium Sections - mill finished as standard, except for exposed wall frames, which are supplied with clear anodised finish. Other colours can be supplied subject to minimum quantity.

C/S TPR Gaskets – supplied in rolls up to 30 metres in length, in Black, White, Grey and Greige as standard (see general information page 34). Other colours can be made available, subject to quantity.

GFT-200/20. Thinline Flush Seal™ floor-to-floor joint cover.

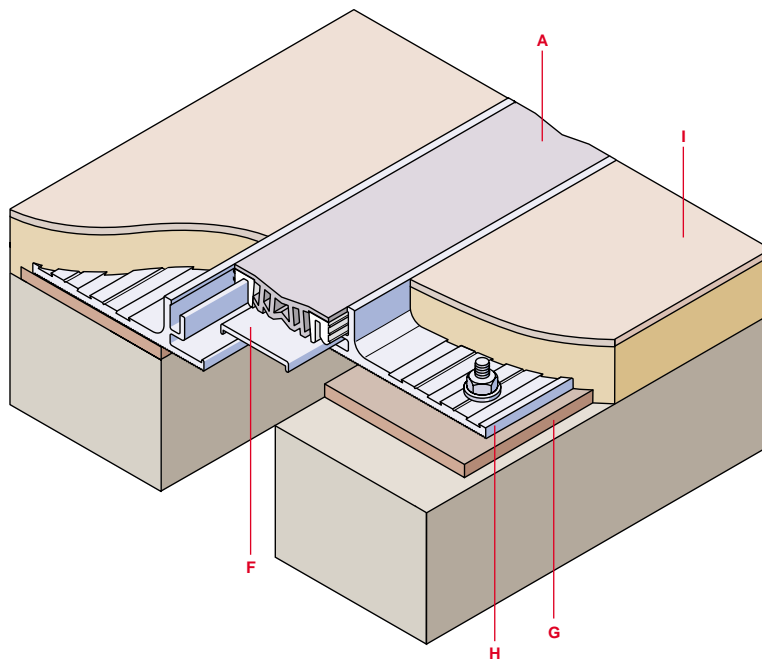

Product Data

Model	Number	Joint Width (mm)	Frame Depth (mm)	Exposed Surface (mm)	Thermal Movement Capacity \pm (mm)			Complementary Wall/Ceiling Joint Covers
					Horizontal	Vertical	Lateral	
GFT	100/20	25.0	20.0	28.0	± 5.0	± 3.0	± 1.5	FWF-100 or FWFP-100
	100/38	25.0	38.0	32.0	± 5.0	± 3.0	± 1.5	FWF-100 or FWFP-100
	100/50	25.0	51.0	32.0	± 5.0	± 3.0	± 1.5	FWF-100 or FWFP-100
	100/75	25.0	75.0	32.0	± 5.0	± 3.0	± 1.5	FWF-100 or FWFP-100
	200/20	50.0	20.0	48.0	± 10.0	$\pm 3.0^*$	± 3.0	FWF-200 or FWFP-200
	200/38	50.0	38.0	48.0	± 10.0	$\pm 3.0^*$	± 3.0	FWF-200 or FWFP-200
	200/50	50.0	51.0	48.0	± 10.0	$\pm 3.0^*$	± 3.0	FWF-200 or FWFP-200
GFTW	100/20	25.0	20.0	28.0	± 5.0	± 3.0	± 1.5	FWFC-100 or FWFCPC-100
	100/38	25.0	38.0	29.0	± 5.0	± 3.0	± 1.5	FWFC-100 or FWFCPC-100
	100/50	25.0	51.0	29.0	± 5.0	± 3.0	± 1.5	FWFC-100 or FWFCPC-100
	100/75	25.0	75.0	29.0	± 5.0	± 3.0	± 1.5	FWFC-100 or FWFCPC-100
	200/20	50.0	20.0	48.0	± 10.0	$\pm 3.0^*$	± 3.0	FWFC-200 or FWFCPC-200
	200/38	50.0	38.0	48.0	± 10.0	$\pm 3.0^*$	± 3.0	FWFC-200 or FWFCPC-200
	200/50	50.0	51.0	48.0	± 10.0	$\pm 3.0^*$	± 3.0	FWFC-200 or FWFCPC-200
GFTB	100/50	25.0	51.0	34.0	± 5.0	± 3.0	± 1.5	N/A
	200/50	50.0	51.0	54.0	± 10.0	$\pm 3.0^*$	± 3.0	N/A
GFTBW	100/50	25.0	51.0	30.0	± 5.0	± 3.0	± 1.5	N/A
	200/50	50.0	51.0	52.0	± 10.0	$\pm 3.0^*$	± 3.0	N/A

* No vertical movement when joint in compression.

GFTB-100/50. Thinline Flush Seal™ floor-to-floor joint cover.

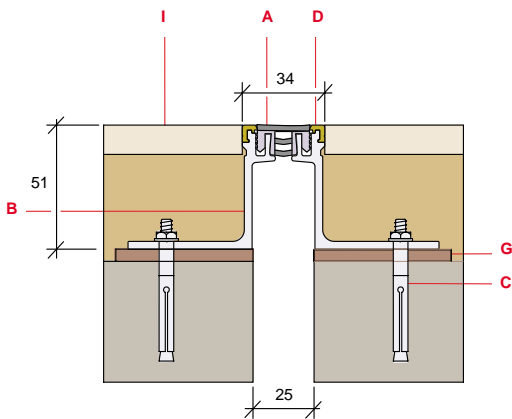

GFT-200/50. Thinline Flush Seal™ floor-to-floor joint cover.

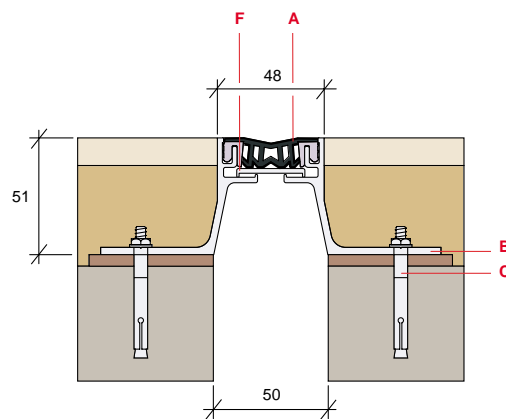

GFTBW-100/50. Thinline Flush Seal™ floor-to-wall joint cover.

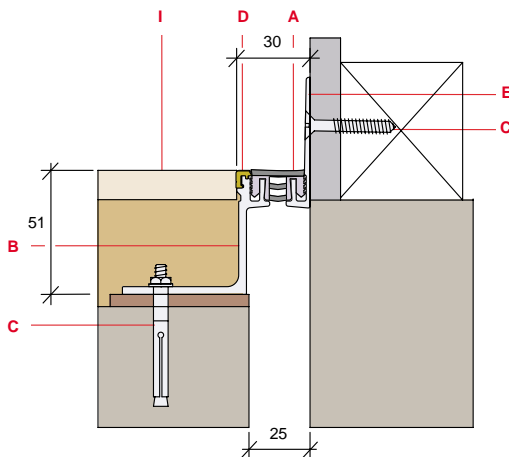

GFTW-200/50. Thinline Flush Seal™ floor-to-wall joint cover.

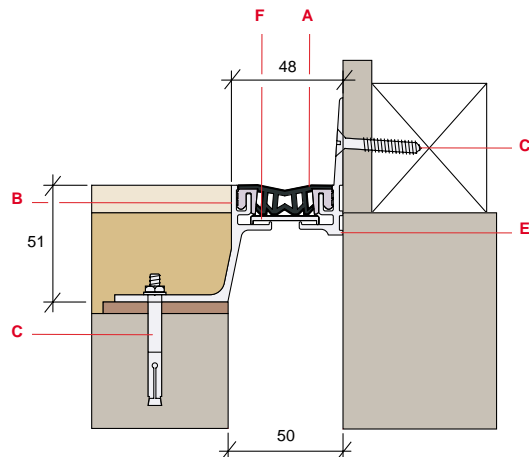

Key for diagrams

- A. C/S TPR gasket
- B. Continuous extruded aluminium side frame (mill finished)
- C. Fixing to suit substrate (by others), please refer to Product Data Sheet
- D. Brass capping section
- E. Continuous extruded aluminium wall frame with clear anodised finish
- F. Continuous extruded aluminium centre plate (mill finished)
- G. Non-shrink self-levelling bedding compound (by others)
- H. Continuous extruded aluminium base frame (mill finished)
- I. Floor finish

Specification Style

Supply and install 120 metres C/S Allway Thinline Flush Seal™ series floor to floor expansion joint cover, model ref: GFT-100/20, complete with Black C/S TPR gasket.

Optional Clauses:

i) Reflex Fire Barrier, to suit 25mm joint width and providing minimum 2 hours integrity and insulation when installed in accordance with manufacturer's instructions.

ii) Vapour Barrier/Water Stop to suit 25mm joint width.

All manufactured and supplied by Construction Specialties (UK) Ltd, Conspec House, St Andrews Way, Bicester Road, Aylesbury, Bucks HP19 8AF
Tel: 01296 611000

C/S Allway® Expansion Joint Covers

Twinline Flush Seal™ Floor Joint Covers (Interior Joints to 100mm)

Recess mounted floor joint covers incorporating dual durometer thermoplastic rubber gasket and an aluminium self-centring assembly retained in place by stainless steel spring clip.

- Flush floor finish
- Replaceable gasket
- Smooth, easy clean surface
- Multi directional movement

GFP

Floor covers with flush centre plate and dual C/S TPR gasket.

GFPW

The floor to wall version of GFP.

GFR

Floor covers with 3.2mm deep recessed centre plate to take a vinyl floor, bonded carpet or other insert.

GFRW

The floor to wall version of GFR.

GFRD

As GFR but with an extra deep (9.5mm) recess to take carpet or tiles.

GFRDW

The floor to wall version of GFRD.

Colours

Aluminium Sections - mill finished as standard, except for exposed wall frames and flush centre plates, which are supplied with clear anodised finish as standard. Other colours can be supplied subject to minimum quantity.

C/S TPR Gaskets – supplied in rolls up to 30 metres in length, in Black, White, Grey and Greige as standard (see general information page 34). Other colours can be made available, subject to quantity.

GFP-200. Twinline Flush Seal™ floor-to-floor joint cover.

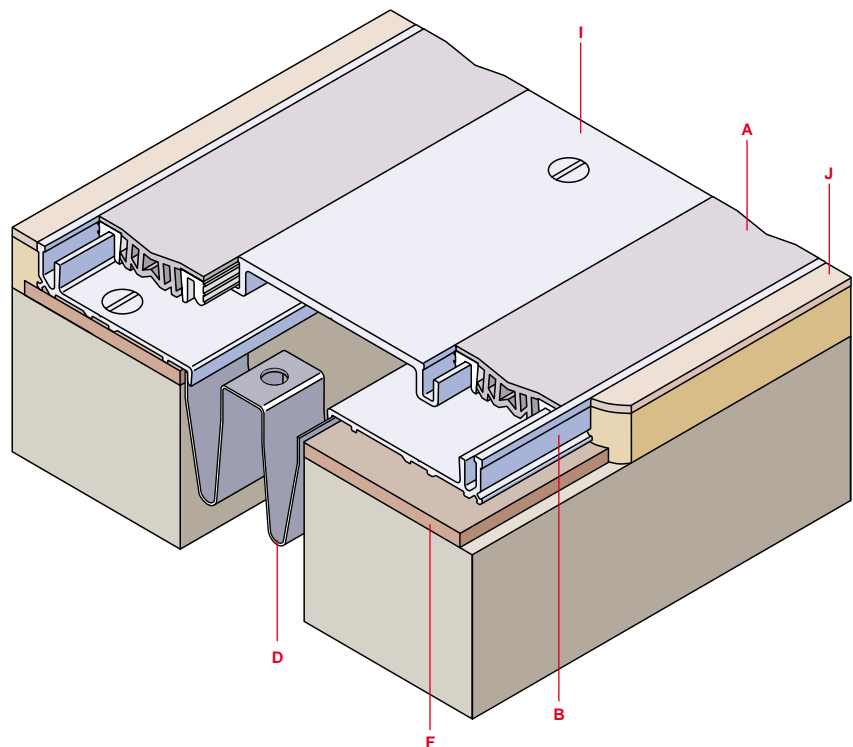

Product Data

Model	Number	Joint Width (mm)	Exposed Surface (mm)	Thermal Movement Capacity ±(mm)		
				Horizontal	Vertical	Lateral
GFP	200	50.0	165.0	±20.0	±12.0	±6.0
	300	75.0	254.0	±38.0	±12.0	±12.0
	400	100.0	280.0	±38.0	±12.0	±12.0
GFPW	200	50.0	108.0	±10.0	0	±3.0
	300	75.0	165.0	±19.0	0	±6.0
	400	100.0	191.0	±19.0	0	±6.0
GFR	200	50.0	165.0	±20.0	±12.0	±6.0
	300	75.0	254.0	±38.0	±12.0	±12.0
	400	100.0	280.0	±38.0	±12.0	±12.0
GFRW	200	50.0	108.0	±10.0	0	±3.0
	300	75.0	165.0	±19.0	0	±6.0
	400	100.0	191.0	±19.0	0	±6.0
GFRD	200	50.0	165.0	±20.0	0	±6.0
	300	75.0	254.0	±38.0	0	±12.0
	400	100.0	280.0	±38.0	0	±12.0
GFRDW	200	50.0	108.0	±10.0	0	±3.0
	300	75.0	165.0	±19.0	0	±6.0
	400	100.0	191.0	±19.0	0	±6.0

GFRD-200. Twinline Flush Seal™ floor-to-floor joint cover.

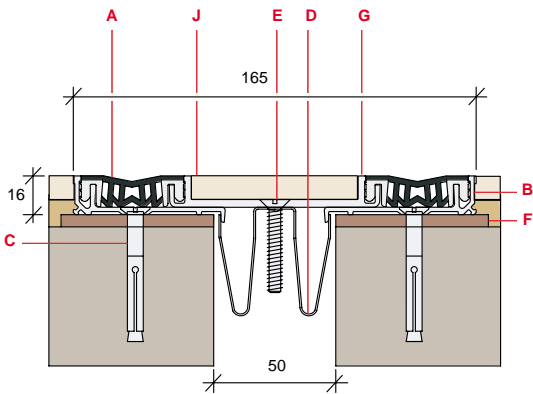

GFR-200. Twinline Flush Seal™ floor-to-floor joint cover.

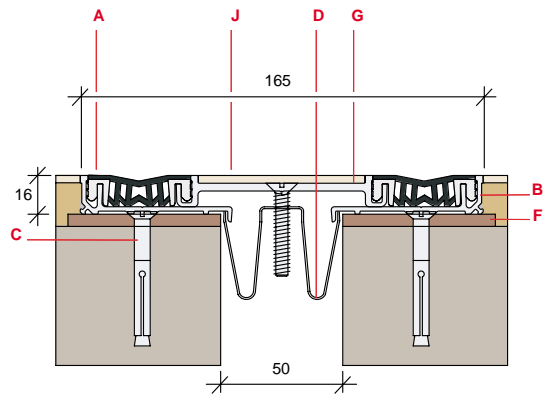

GFRDW-200. Twinline Flush Seal™ floor-to-wall joint cover.

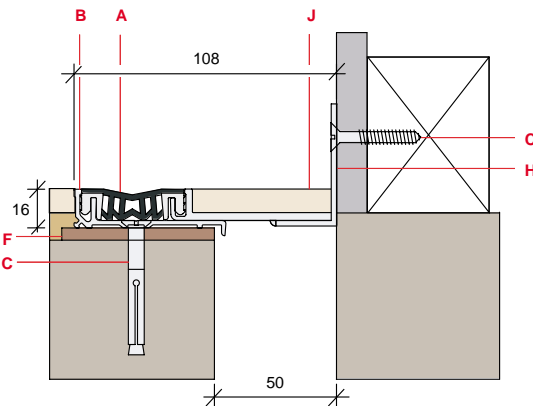

GFRW-200. Twinline Flush Seal™ floor-to-wall joint cover.

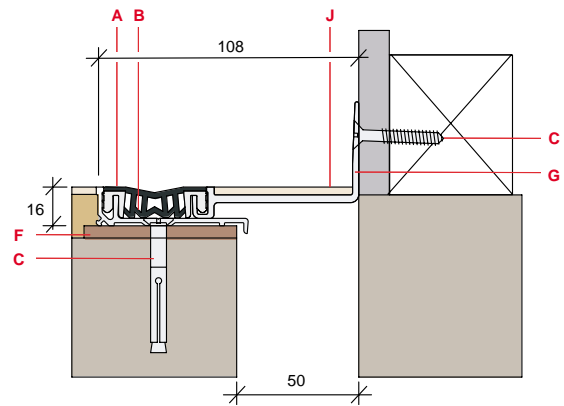

Key for diagrams

- A. C/S TPR gasket
- B. Continuous extruded aluminium side frame (mill finished)
- C. Fixing to suit substrate (by others), please refer to Product Data Sheet
- D. 50mm wide stainless steel spring clips at 450mm centres
- E. Machine screw
- F. Non-shrink self-levelling bedding compound (by others)
- G. Continuous extruded aluminium recessed centre plate, supplied mill finished (deep recess for models GFRD and GFRDW)
- H. Aluminium angle welded to centre plate (mill finished)
- I. Continuous extruded aluminium flush centre plate with clear anodised finish
- J. Floor finish

Specification Style

Supply and install 180 metres C/S Allway Twinline Flush Seal™ floor to floor expansion joint cover, model ref: GFR-200, complete with Black C/S TPR gasket.

Optional Clauses:

- i) Reflex Fire Barrier, to suit 50mm joint width and providing minimum 2 hours integrity and insulation when installed in accordance with manufacturer's instructions.
- ii) Vapour Barrier/Water Stop to suit 50mm joint width

All manufactured and supplied by Construction Specialties (UK) Ltd, Conspec House, St Andrews Way, Bicester Road, Aylesbury, Bucks HP19 8AF Tel: 01296 611000

C/S Allway® Expansion Joint Covers

Heavy Duty Floor Joint Covers (Interior/Exterior Joints to 100mm)

Specialised expansion joint covers for situations where the required loadings are far in excess of those normally encountered.

Twinline Flush Seal™ Heavy Duty Floor Joint Covers

GFP-HD

Heavy duty floor to floor covers for up to 100mm wide joints, which also allow some vertical shear movement.

GFPW-HD

Floor to wall version of GFP-HD

Heavy Duty Seal Floor Joint Covers

Recess mounted models

HO 50/40

Heavy duty floor to floor cover for 50mm wide joints

HO 50/40P

Floor to wall version of HO 50/40

HO 50/40PD

Similar to HO 50/40P but with an alternative, extended wall frame suitable for 65mm wide joints

Surface mounted models

RLO 50/31

Heavy duty floor to floor joint cover for 55mm wide joints

RLO 50/31P

Heavy duty floor to wall version of RLO-50/31

RLO 50/31PD

Similar to RLO 50/31P, but with an alternative extended wall frame, suitable for 70mm wide joints

Colours

Aluminium Sections – mill finished as standard, except for exposed wall frames and flush centre plates, which are supplied with clear anodised finish as standard. Other colours can be supplied subject to minimum quantity.

GFP-200HD. Twinline Flush Seal™ heavy duty floor-to-floor joint cover.

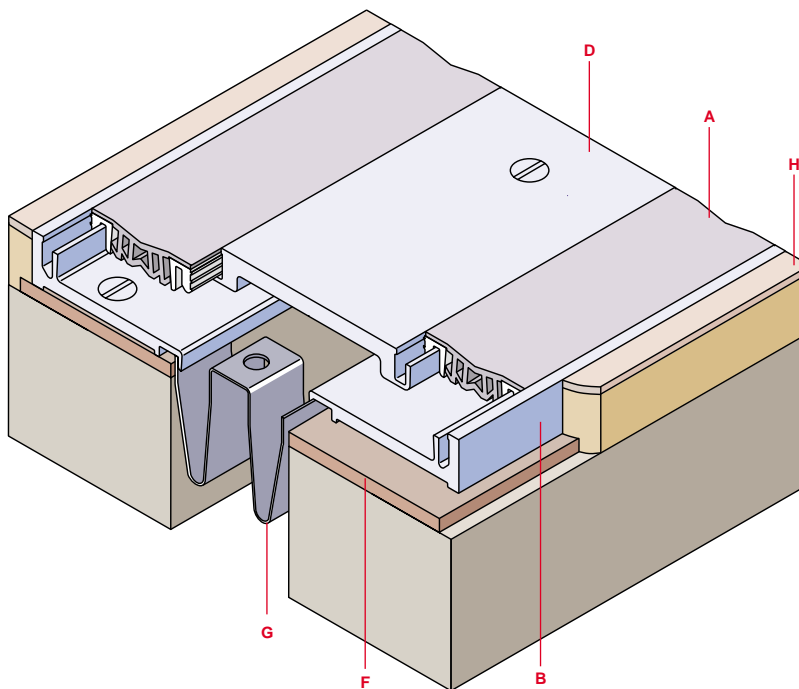

Product Data

Model	Number	Joint Width (mm)	Exposed Surface (mm)	Thermal Movement Capacity \pm (mm)		
				Horizontal	Vertical	Lateral
GFP-HD	200	50.0	168.0	\pm 20.0	\pm 6.0	\pm 6.0
	300	75.0	257.0	\pm 38.0	\pm 12.0	\pm 12.0
	400	100.0	283.0	\pm 38.0	\pm 12.0	\pm 12.0
GFPW-HD	200	50.0	110.0	\pm 10.0	0	\pm 3.0
	300	75.0	167.0	\pm 19.0	0	\pm 6.0
	400	100.0	192.0	\pm 19.0	0	\pm 6.0
HO	50/40	50.0	55.0	\pm 10.0	0	0
	50/40P	50.0	55.0	\pm 10.0	0	0
	50/40PD	65.0	70.0	\pm 10.0	0	0
RLO	50/31	55.0	210.0	\pm 10.0	0	0
	50/31P	55.0	130.0	\pm 10.0	0	0
	50/31PD	70.0	145.0	\pm 10.0	0	0

C/S TPR Gaskets (models GFP(W)-HD) – supplied in rolls up to 30 metres in length, in Black, White, Grey and Greige as standard (see general information page 34). Other colours can be made available, subject to quantity.

Flexible PVC Gaskets (models HO and RLO) – Black and Grey as standard.

HO-50/40. Heavy Duty Seal floor-to-floor joint cover.

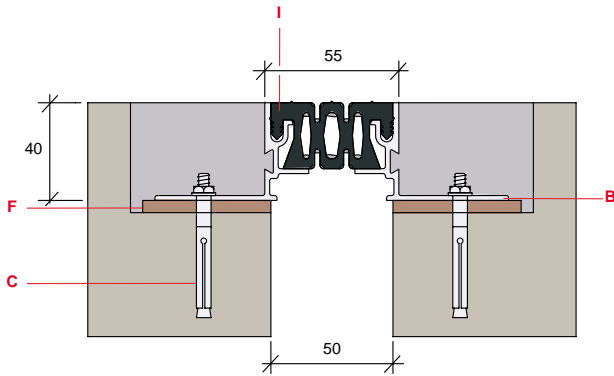

RLO-50/31. Heavy Duty Seal floor-to-floor joint cover.

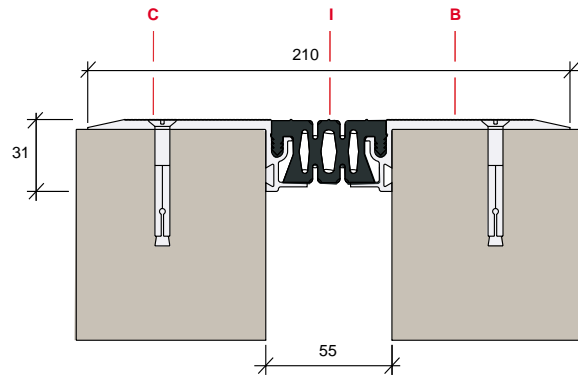

GFPW-200HD. Twinline Flush Seal™ heavy duty floor-to-wall joint cover.

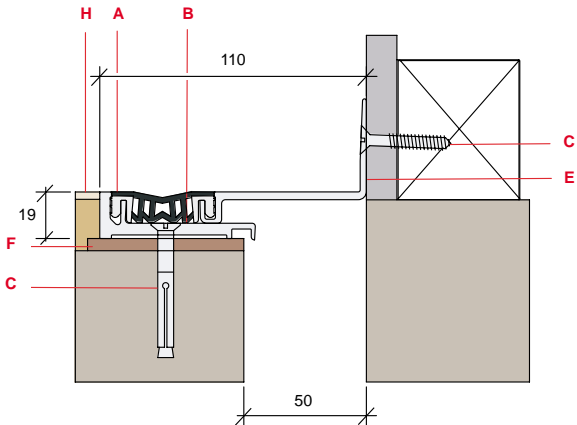

RLO-50/31PD. Heavy Duty Seal floor-to-wall joint cover.

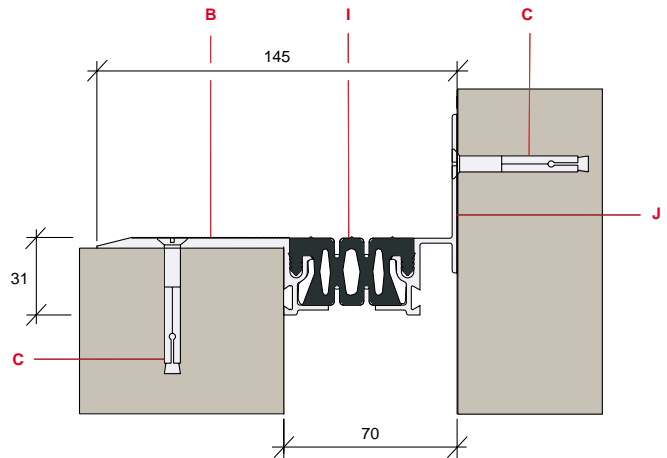

Key for diagrams

- A. C/S TPR gasket
- B. Continuous extruded aluminium side frame (mill finished)
- C. Fixing to suit substrate (by others), please refer to Product Data Sheet
- D. Continuous extruded aluminium centre plate with clear anodised finish
- E. Continuous extruded aluminium wall frame with clear anodised finish
- F. Non-shrink self levelling bedding compound (by others)
- G. 50mm wide stainless steel spring clips @ 450mm centres
- H. Floor finish
- I. Flexible PVC gasket (EPDM gasket optional)
- J. Continuous extruded aluminium wall frame (mill finished)

Specification Style

Supply and install 54 metres C/S Allway Twinline Flush Seal™ heavy duty floor to floor expansion joint cover, model ref: GFPW-200HD, complete with Grey C/S TPR Gasket.

Optional Clauses:

- i) Reflex Fire Barrier, to suit 50mm joint width and providing minimum 2 hours integrity and insulation when installed in accordance with manufacturer's instructions.
- ii) Vapour Barrier/Water Stop to suit 50mm joint width.

All manufactured and supplied by Construction Specialties (UK) Ltd, Conspec House, St Andrews Way, Bicester Road, Aylesbury, Bucks HP19 8AF
Tel: 01296 611000

C/S Allway® Expansion Joint Covers

Twinline Large Span Floor Joint Covers (Interior/Exterior Joints to 250mm)

Twinline Large Span floor joint covers are designed to span structural joints ranging from 100mm to 250mm.

- Totally flush finish
- Self-centering centre plate

SSR

Large span floor joint covers suitable for interior and exterior applications. Recessed centre plate capable of accepting up to 38mm deep marble, granite or limestone slabs, making the joint minimally visible.

SSRW

The floor to wall version of SSR

SGR

Large span joint with twin C/S TPR gaskets and a recessed cover plate to allow a flush floor finish

SGRW

The floor to wall version of SGR

SGP

As the SGR but with a plain cover plate. Optional bronze anodised or stainless steel cover plate.

SGPW

The floor to wall version of SGP

Colours

Aluminium sections – mill finished as standard, except for SGP models centre plate, which is supplied with clear anodised finish as standard. Other colours can be supplied subject to minimum quantity.

C/S TPR Gaskets – supplied in rolls up to 30 metres in length, in Black, White, Grey and Greige as standard (see general information page 34). Other colours can be made available, subject to quantity.

SSR-400. Twinline Large Span floor-to-floor joint cover.

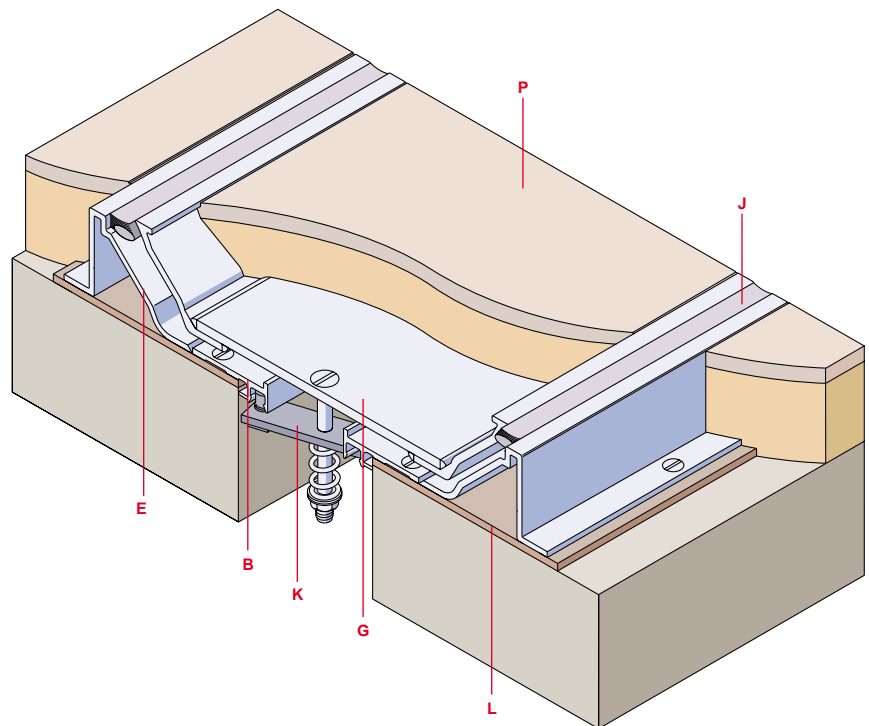

Product Data

Model	Number	Joint Width (mm)	Exposed Surface (mm)	Thermal Movement Capacity ±(mm)			Complementary Wall/ Ceiling Joint Covers
				Horizontal	Vertical	Lateral	
SSR*	400	100.0	328.0	±20.0	0	±6.0	N/A
	500	125.0	352.0	±20.0	0	±6.0	N/A
	600	150.0	378.0	±20.0	0	±6.0	N/A
	700	175.0	403.0	±20.0	0	±6.0	N/A
	800	200.0	479.0	±20.0	0	±6.0	N/A
	900	225.0	505.0	±20.0	0	±6.0	N/A
SSRW*	400	100.0	214.0	±10.0	0	±3.0	N/A
	500	125.0	240.0	±10.0	0	±3.0	N/A
	600	150.0	265.0	±10.0	0	±3.0	N/A
	700	175.0	291.0	±10.0	0	±3.0	N/A
	800	200.0	341.0	±10.0	0	±3.0	N/A
	900	225.0	367.0	±10.0	0	±3.0	N/A
SGR*/SGP*	400	100.0	280.0	±25.0	±3.0	±12.0	N/A
	500	125.0	305.0	±25.0	±3.0	±12.0	SGW-500
	600	150.0	330.0	±25.0	±3.0	±12.0	SGW-600
	700	175.0	381.0	±25.0	±3.0	±12.0	SGW-700
	800	200.0	406.0	±25.0	±3.0	±12.0	SGW-800
	900	225.0	457.0	±25.0	±3.0	±12.0	SGW-900
SGRW*/SGPW*	400	100.0	191.0	±12.0	0	±6.0	N/A
	500	125.0	216.0	±12.0	0	±6.0	SGWC-500
	600	150.0	241.0	±12.0	0	±6.0	SGWC-600
	700	175.0	279.0	±12.0	0	±6.0	SGWC-700
	800	200.0	311.0	±12.0	0	±6.0	SGWC-800
	900	225.0	342.0	±12.0	0	±6.0	SGWC-900
	1000	250.0	368.0	±12.0	0	±6.0	SGWC-1000

* These joint covers can be used in seismic areas. Larger sizes available. For details contact our Technical Department on 01296 611000

SGP-400. Twinline Large Span floor-to-floor joint cover.

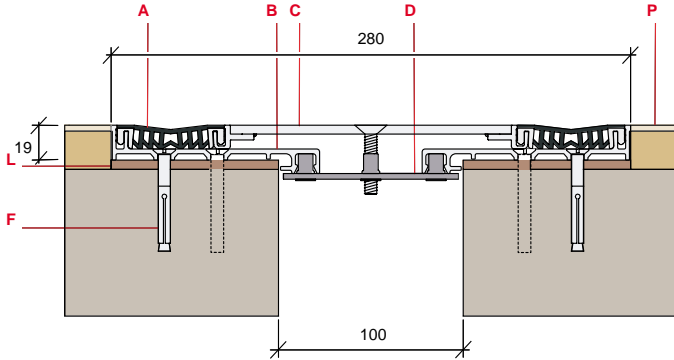

Key for diagrams

- A. C/S TPR gasket
- B. Continuous extruded aluminium turnbar frame
- C. Aluminium centre plate (flush for SGP/W models and recessed for SGR/W models) welded to aluminium adaptors
- D. Steel turnbar assembly @ 450mm centres
- E. Continuous extruded aluminium frame
- F. Fixing to suit substrate (by others), please refer to Product Data Sheet
- G. Continuous extruded aluminium pan nosing (welded to aluminium centre plate)
- H. Self levelling grout (by others) to be installed on site
- J. Caulk and backer rod (by others)
- K. Steel channel turnbar assembly @ 450mm centres
- L. Non-shrink self-levelling bedding compound (by others)
- M. Continuous extruded aluminium hinge nosing welded to aluminium centre plate
- N. Caulk (by others)
- O. Continuous extruded aluminium hinge frame
- P. Floor finish

SGR-400. Twinline Large Span floor-to-floor joint cover.

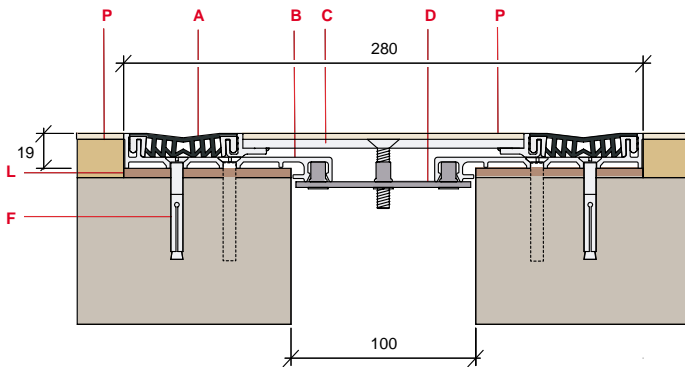

Specification Style

Supply and install 42 meters C/S Allway Twinline Large Span floor to wall expansion joint cover, model ref: SGRW-800.

Optional Clauses:

- i) Multiflex Fire Barrier, to suit 200mm joint width and providing minimum 2 hours integrity and insulation when installed in accordance with manufacturer's instructions.
- ii) Vapour Barrier/Water Stop to suit 200mm joint width.

All manufactured and supplied by Construction Specialties (UK) Ltd, Conspec House, St Andrews Way, Bicester Road, Aylesbury, Bucks HP19 8AF. Tel: 01296 611000

SSRW-400. Twinline Large Span floor-to-wall joint cover.

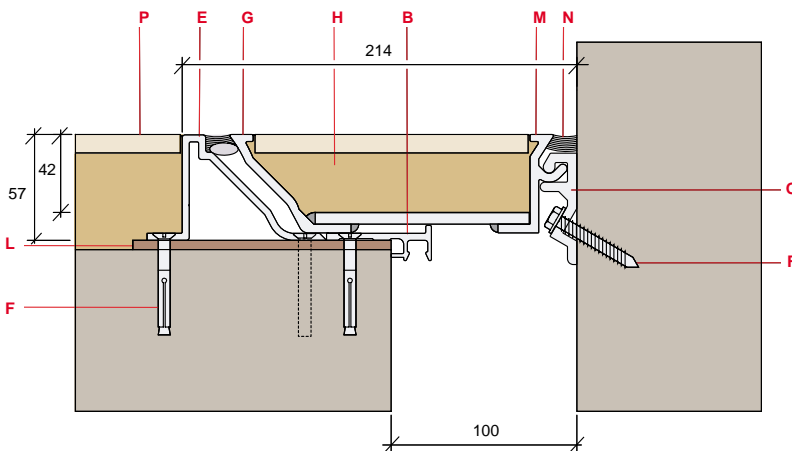

C/S Allway® Expansion Joint Covers

Thinline Flush Seal™ Wall and Ceiling Joint Covers (Interior Joints to 100mm)

Thinline Flush Seal™ wall/ceiling joint covers feature an easily replaceable, co-extruded C/S TPR Gasket, which has been designed to remain flush and in place during the entire movement cycle. Both surface and recess mounted models are available.

- Flush wall and ceiling finish
- Replaceable gasket
- Smooth, easy clean surface
- Multi directional movement

FGFS

Surface mounted expansion joint covers suitable for most types of wall construction

FGFSC

The corner, or wall to ceiling versions of FGFS

FWF

Standard flush finish recess mounted expansion joint covers for dry lined walls

FWFC

The corner, or wall to ceiling versions of FWF

FWFP

Similar to FWF, but designed for use with plaster finished walls

FWFPC

The corner, or wall to ceiling versions of FWFP

Colours

Aluminium sections are clear anodised as standard for surface mounted models and mill finished for recess mounted models.

Other colours can be supplied subject to minimum quantity.

C/S TPR Gaskets – supplied in rolls up to 30 metres in length, in Black, White, Grey and Greige as standard (see general information page 34). Other colours can be made available, subject to quantity.

FWF-100. Thinline Flush Seal™ wall-to-wall joint cover.

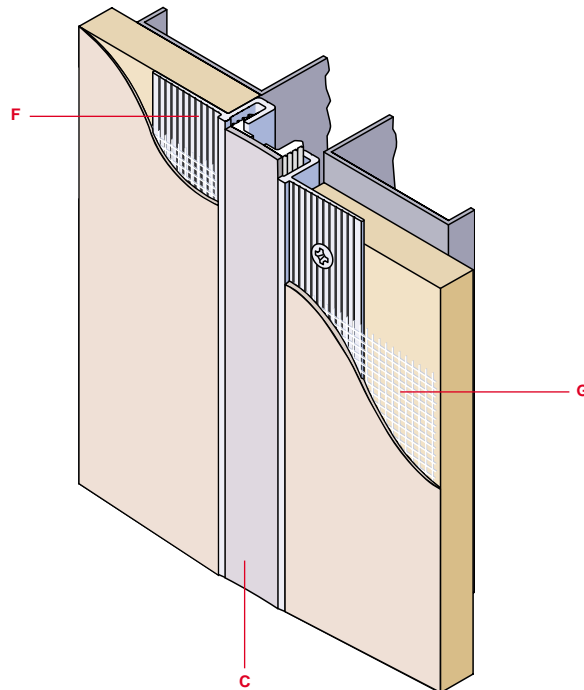

Product Data

Model	Number	Joint Width (mm)	Exposed Surface (mm)	Thermal Movement Capacity ±(mm)			Complementary Floor Joint Covers
				Horizontal	Vertical	Lateral	
FGFS	80	20.0	105.0	3.0	0	0	GFS-80
	100	25.0	110.0	5.0	±3.0	0	GFS-100 or GFST-100
	200	50.0	130.0	10.0	±3.0	±3.0	GFS-200 or GFST-200
FGFSC	80	20.0	63.0	3.0	0	0	GFSW-80
	100	25.0	67.0	5.0	±3.0	0	GFSW-100 or GFSTW-100
	200	50.0	90.0	10.0	±3.0	±3.0	GFSW-200 or GFSTW-200
FWF	100	25.0	27.0	5.0	±3.0	0	GFPS-100
	200	50.0	48.0	10.0	±3.0	±3.0	GFPS-200
FWFC	100	25.0	24.0	5.0	±3.0	0	GFPSW-100 or GFTW-100
	200	50.0	49.0	10.0	±3.0	±3.0	GFPSW-200 or GFTW-200
FWFP	100	25.0	26.0	5.0	±3.0	0	GFT-100
	200	50.0	48.0	10.0	±3.0	±3.0	GFT-200
FWFPC	100	25.0	26.0	5.0	±3.0	0	GFTW-100
	200	50.0	48.0	10.0	±3.0	±3.0	GFTW-200

FGFS-80. Thinline Flush Seal™ wall-to-wall joint cover.

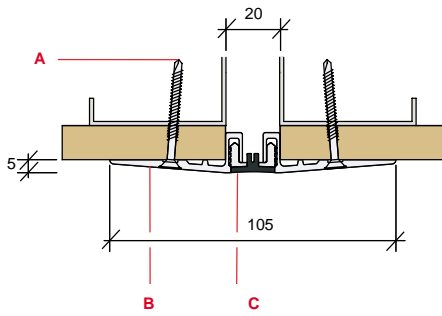

FGFSC-80. Thinline Flush Seal™ corner wall joint cover.

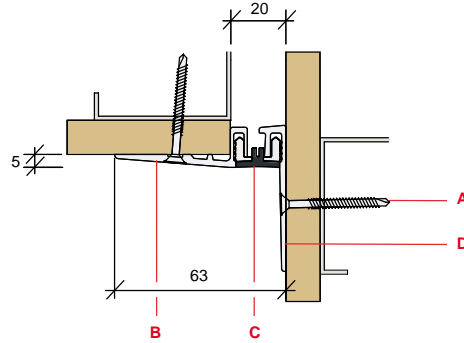

FWFC-100. Thinline Flush Seal™ corner wall joint cover.

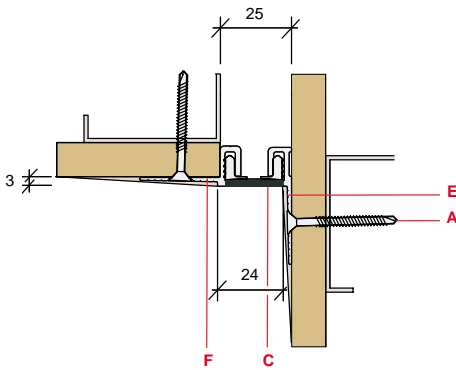

FWFPC-200. Thinline Flush Seal™ corner wall joint cover.

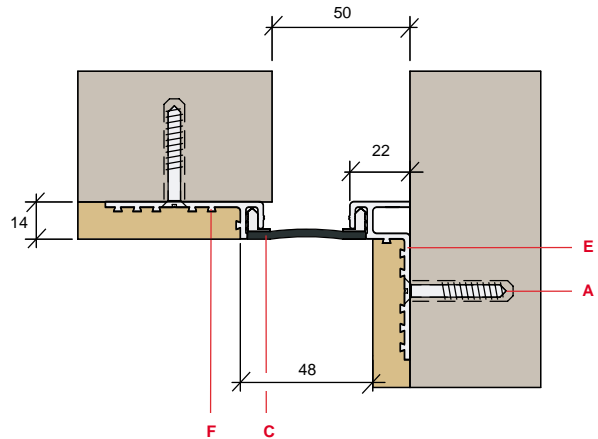

Key for diagrams

- A. Fixing to suit substrate (by others), please refer to Product Data Sheet
- B. Continuous extruded aluminium wall frame with clear anodised finish
- C. C/S TPR gasket
- D. Continuous extruded aluminium corner wall frame with clear anodised finish
- E. Continuous extruded aluminium corner wall frame (mill finished)
- F. Continuous extruded aluminium wall frame (mill finished)
- G. 50mm wide self-adhesive fibreglass scrim tape (by others).

Specification Style

Supply and install 85 metres C/S Allway Thinline Flush Seal™ wall to wall expansion joint cover, model ref: FGFS-200, complete with Grey C/S TPR gasket.

Optional Clauses:

- i) Reflex Fire Barrier, to suit 50mm joint width and providing minimum 2 hours integrity and insulation when installed in accordance with manufacturer's instructions.

All manufactured and supplied by Construction Specialties (UK) Ltd, Conspec House, St Andrews Way, Bicester Road, Aylesbury, Bucks HP19 8AF. Tel: 01296 611000

C/S Allway® Expansion Joint Covers

Thinline Flush Seal™ Wall and Ceiling Joint Covers (Interior Joints to 100mm)

Recess mounted wall/ceiling expansion joint covers incorporating a 'concertina' type continuous extruded flexible primary seal.

- Flush wall and/or ceiling finish
- Replaceable primary seal
- Multi directional movement

FWS

Wall or ceiling covers incorporating a 'concertina' type primary seal.

FWSC

The corner versions of FWS

FCS

'Concertina' type suspended ceiling joint covers.

FCSC

The corner versions of FCS

HC

'Concertina' type suspended ceiling joint covers incorporating continuous co-extruded white PVC.

Colours

Aluminium sections are mill finished as standard. Other colours can be supplied subject to minimum quantity.

'Concertina' type primary seals available in

Black, Grey and White as standard (see general information page 34). Other colours can be made available, subject to quantity.

HC model incorporates white co-extruded

PVC

FWS-200. Thinline Flush Seal™ wall-to-wall joint cover.

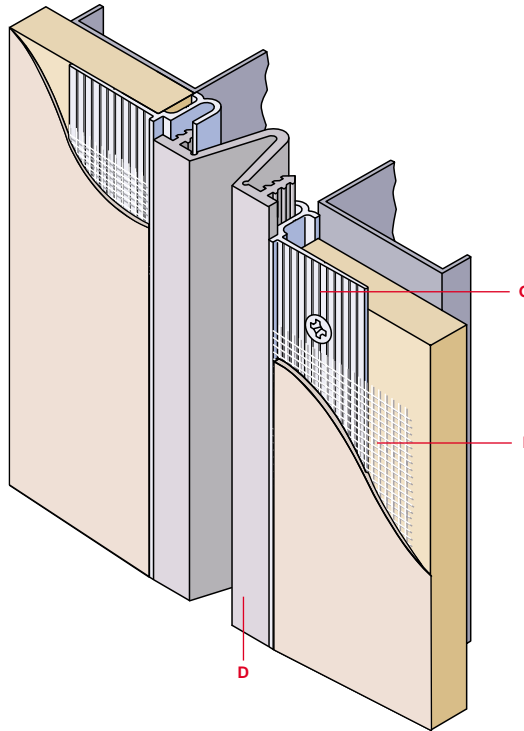

Product Data

Model	Number	Joint Width (mm)	Exposed Surface (mm)	Thermal Movement Capacity ±(mm)		
				Horizontal	Vertical	Lateral
FWS	200	50.0	50.0	±25.0	±6.0	±6.0
	300	75.0	75.0	±50.0	±6.0	±6.0
	400	100.0	100.0	±75.0	±6.0	±6.0
FWSC	200	50.0	50.0	±25.0	±6.0	±6.0
	300	75.0	75.0	±50.0	±6.0	±6.0
	400	100.0	100.0	±75.0	±6.0	±6.0
FCS	200	50.0	50.0	±25.0	±6.0	±6.0
	300	75.0	75.0	±50.0	±6.0	±6.0
	400	100.0	100.0	±75.0	±6.0	±6.0
FCSC	200	50.0	50.0	±25.0	±6.0	±6.0
	300	75.0	75.0	±50.0	±6.0	±6.0
	400	100.0	100.0	±75.0	±6.0	±6.0
HC	100	25.0	25.0	±25.0	±3.0	0
	200	50.0	50.0	±25.0	±3.0	0
	300	75.0	75.0	±50.0	±3.0	0
	400	100.0	100.0	±50.0	±3.0	0

FCS-300. Thinline Flush Seal™ ceiling joint cover.

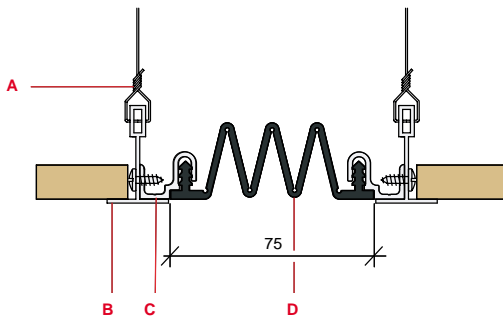

FCSC-300. Thinline Flush Seal™ ceiling-to-wall joint cover.

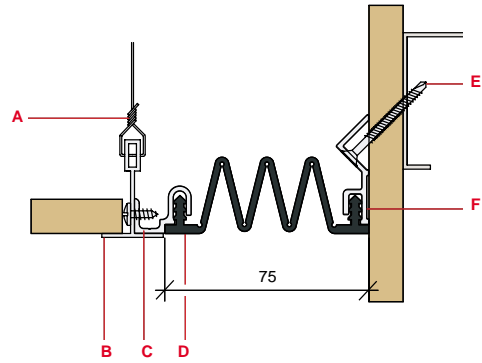

FWSC-200. Thinline Flush Seal™ corner wall joint cover.

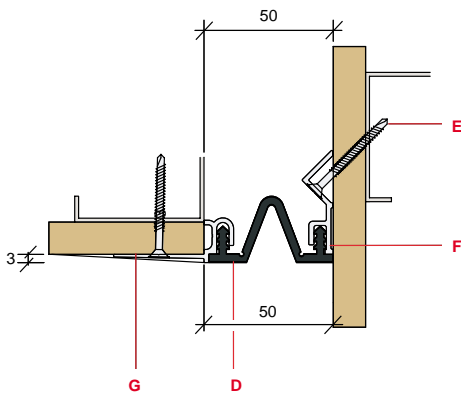

HC-100. Thinline Flush Seal™ ceiling joint cover.

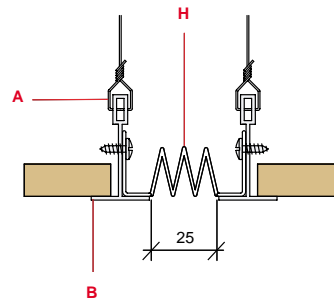

Key for diagrams

- A. Suspended ceiling hanger (by others)
- B. Suspended ceiling (by others)
- C. Continuous extruded aluminium ceiling frame (mill finished)
- D. Flexible primary seal
- E. Fixing to suit substrate (by others), please refer to Product Data Sheet
- F. Continuous extruded aluminium corner wall frame (mill finished)
- G. Continuous extruded aluminium wall frame (mill finished)
- H. Continuous co-extruded white PVC
- I. 50mm wide self-adhesive fibreglass scrim tape (by others).

Specification Style

Supply and install 105 metres C/S Allway Thinline Flush Seal™ ceiling to ceiling expansion joint cover, model ref: FCS-200, complete with White C/S TPR gasket.

Optional Clauses:

- i) Reflex Fire Barrier, to suit 50mm joint width and providing minimum 2 hours integrity and insulation when installed in accordance with manufacturer's instructions.

All manufactured and supplied by Construction Specialties (UK) Ltd, Conspec House, St Andrews Way, Bicester Road, Aylesbury, Bucks HP19 8AF
Tel: 01296 611000

C/S Allway® Expansion Joint Covers

Large Span Wall Joint Covers (Interior and Exterior Joints to 250mm)

SGW

Series of interior wall joint covers featuring C/S TPR Gaskets, designed for large wall joints where a flush finish is required. The aluminium faced centre plate can be painted or covered for maximum concealment.

SGWC

The corner version of SGW

SC

These 'concertina' type profiles incorporate primary and secondary seals and have no exposed fasteners. Heat welded weather tight transitions and primary seals containing UV inhibitors, to prevent embrittlement and fading, making them especially suitable for exterior applications.

Colours

Visible aluminium sections - standard finish is clear anodise. Other colours can be supplied subject to minimum quantity.
C/S TPR Gaskets – supplied in rolls up to 30 metres in length, in Black, White, Grey and Greige as standard (see general information page 34). Other colours can be made available, subject to quantity.

SC series – primary seals are black as standard, special colours available subject to quantity.

Key for diagrams

- A. Fixing to suit substrate (by others), please refer to Product Data Sheet
- B. Continuous extruded aluminium wall frame
- C. C/S TPR gasket
- D. Stainless steel channel turnbar assembly @ 450mm centres
- E. Factory formed aluminium panel
- F. Continuous extruded aluminium turnbar retainer
- G. Continuous extruded aluminium panel frame
- H. Continuous extruded flexible primary seal
- I. Continuous extruded PVC secondary seal
- J. Continuous extruded aluminium side frame
- K. Continuous butyl tape

SGW-500. Large Span wall-to-wall joint cover.

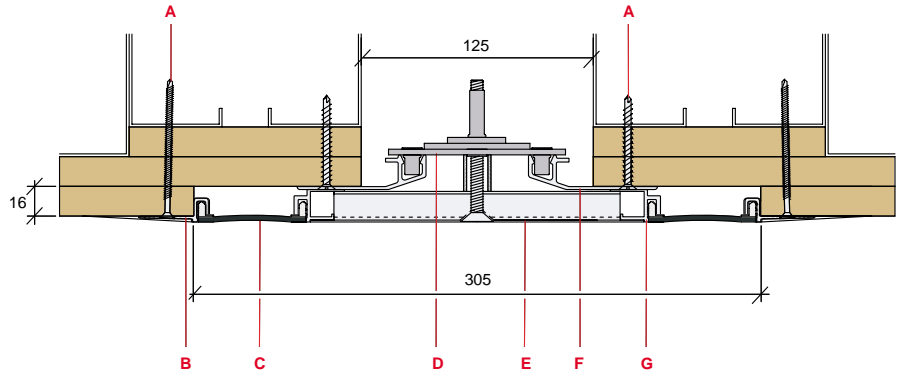

SC-200. Large Span exterior wall-to-wall joint cover.

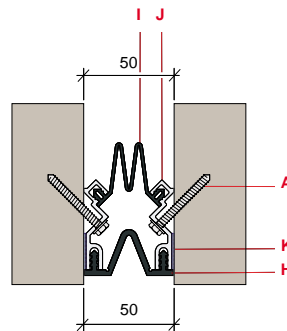

Product Data

Model	Number	Joint Width (mm)	Exposed Surface (mm)	Thermal Movement Capacity ±(mm)			Complementary Floor Joint Covers
				Horizontal	Vertical	Lateral	
SGW*	500	125.0	305.0	±25.0	0	±6.0	SGR-500 or SGP-500
	600	150.0	330.0	±25.0	0	±6.0	SGR-600 or SGP-600
	700	175.0	381.0	±25.0	0	±6.0	SGR-700 or SGP-700
	800	200.0	406.0	±25.0	0	±6.0	SGR-800 or SGP-800
	900	225.0	457.0	±25.0	0	±6.0	SGR-900 or SGP-900
	1000	250.0	483.0	±25.0	0	±6.0	SGR-1000 or SGP-1000
SGWC*	500	125.0	216.0	±12.0	0	±6.0	SGRW-500 or SGPW-500
	600	150.0	241.0	±12.0	0	±6.0	SGRW-600 or SGPW-600
	700	175.0	279.0	±12.0	0	±6.0	SGRW-700 or SGPW-700
	800	200.0	305.0	±12.0	0	±6.0	SGRW-800 or SGPW-800
	900	225.0	343.0	±12.0	0	±6.0	SGRW-900 or SGPW-900
	1000	250.0	368.0	±12.0	0	±6.0	SGRW-1000 or SGPW-1000
SC*	200	50.0	50.0	±25.0	0	0	N/A
	300	75.0	75.0	±50.0	0	0	N/A
	400	100.0	100.0	±75.0	0	0	N/A
	500	125.0	125.0	±100.0	0	0	N/A
	600	150.0	150.0	±125.0	0	0	N/A
	700	175.0	175.0	±150.0	0	0	N/A
	800	200.0	200.0	±175.0	0	0	N/A
	900	225.0	225.0	±200.0	0	0	N/A
	1000	250.0	250.0	±225.0	0	0	N/A

SGW(C) joints can be used in seismic areas.

* Larger sizes available. For details contact our Technical Department on 01296 611000