

EXTERIOR GASKETED WALL JOINT COVERS

JOINTS TO 150MM – MOVEMENT UP TO +150MM AND -90MM



Bank Headquarters, London

- Exterior vertical applications where weather protection is critical
- Frames designed to attach to most exterior finishes
- No exposed fasteners
- Multi-directional movement
- Primary gaskets available in flush or concertina type options

How it works



Snap-in continuous secondary PVC gasket for weather integrity.



Gaskets expand and compress during movement, while providing a weather tight seal.

Primary gasket contains UV inhibitors to prevent embrittlement and minimise fading.

SC series

Wall joint covers comprising of continuous aluminium frames, a concertina type Santoprene primary gasket and a secondary PVC gasket. These covers are designed to accommodate up to 80% of horizontal movement. Heat welded weather tight transitions are available if required.

Wall to wall or corner wall covers

Model	Joint width* (mm)	Exposed surface (mm)	Movement ± (mm)		
					
SC-200	50	50	+50/-20	±10	±6
SC-300	75	75	+75/-40	±15	±6
SC-400	100	100	+100/-70	±20	±6
SC-500	125	125	+125/-70	±20	±6
SC-600	150	150	+150/-90	±20	±6

* Larger sizes available, please contact us for details

Colours and finishes

Primary gaskets are available in four standard gasket colours[‡]. Aluminium side frames are supplied mill finished.

Accessories

Optional Fire Barriers, see p.44 for details.

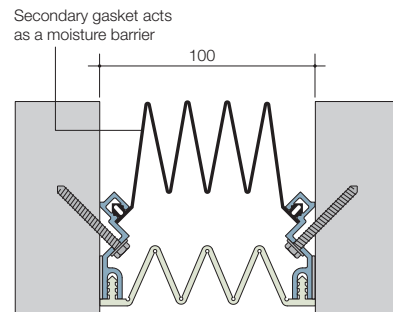

SC-400

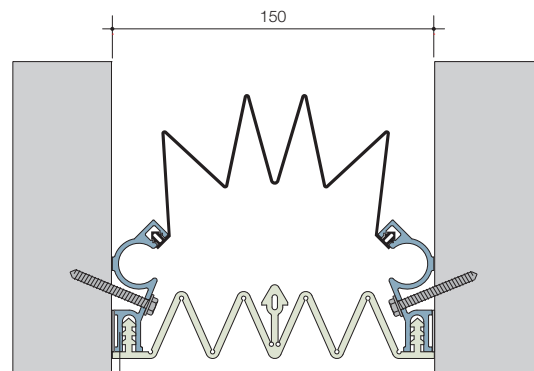



SC-600

SF series

Wall cover systems comprising of a flush Santoprene primary gasket and a secondary PVC gasket positioned in continuous extruded aluminium side frames. Heat welded weather tight transitions are available if required.

Wall to wall or corner wall covers

Model	Joint width* (mm)	Exposed surface (mm)	Movement ± (mm)		
					
SF-300	75	75	+35/-40	±15	±3
SF-400	100	100	+50/-70	±20	±3
SF-500	125	125	+65/-70	±15	±3
SF-600	150	150	+75/-90	±15	±3

* Larger sizes available, please contact us for details

Colours and finishes

Primary gaskets are available in four standard gasket colours[‡]. Aluminium side frames are supplied mill finished.

Accessories

Optional Fire Barriers, see p.44 for details.

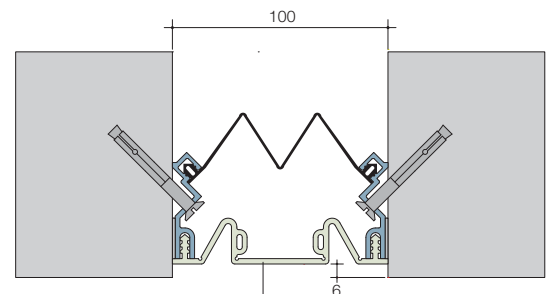

SF-400

[‡]Santoprene Gasket Colours

Black

White

Grey

Greige